



AC/DC 20AC/20DC Position
Circuit Breaker Panel

- Ready for installation of optional 8069 Label Backlight System (4 required)
- Includes set of 30 common AC and 30 common DC labels, backlightable (see page 29)
- All AC and DC buses installed, fully pre-wired

AC Features Common to 8086 and 8186 Panels

- Two separate AC load groups with transfer switch to combine into one load group
- Switch allows ammeter and voltmeter to read either AC load group
- Twenty AC circuit breaker positions
- 0-50 Amp AC ammeter with remote sensing coil
- Reverse polarity indicators on both AC load groups



8086 Panel

***€** Marked version is 8186 Panel

AC Features of 8086 Panel only

- Six 15 Amp A-Series circuit breakers installed
- Four double-pole 30 Amp A-Series AC main circuit breakers with lockout slides
- 0-150 Volt AC voltmeter

AC Features of 8186 **€** Marked Panel only

- Six 8 Amp B-Series circuit breakers installed
- Four double-pole 16 Amp B-Series AC main circuit breakers with lockout slides
- 0-250 Volt AC voltmeter

DC Features Common to 8086 and 8186 Panels

- Twenty DC circuit breaker positions, fourteen 15A circuit breakers installed
- 8-16 Volt voltmeter with 3 position switch for multiple battery banks
- 0-50A ammeter with remote shunt

Specifications

Voltage	8086 12 Volts DC / 120 Volts AC 8186 12 Volts DC / 230 Volts AC
Amperage	Panel Main Bus 100 AAC / 100 ADC
Weight	12.80 Lb / 5.81 Kg
Dimensions	11.50" / 292.10 mm high 19.50" / 495.30 mm wide

PN Description

8086	40 Position AC/DC Panel, A-Series Circuit Breakers
8186	40 Position AC/DC Panel, € Marked, B-Series Circuit Breakers

See pages 35-39 for meter specifications.
See pages 29-32 for circuit breaker panel accessories.



AC/DC 8AC/16 DC Position Circuit Breaker Panel

- Ready for installation of optional 8065 Label Backlight System (3 required)
- Includes set of 30 common AC and 30 common DC labels, backlightable (see page 29)
- All AC and DC buses installed, fully pre-wired

AC Features Common to 8084 and 8184 Panels

- Eight AC circuit breaker positions
- Reverse polarity indicator

AC Features of 8084 Panel only

- Three 15 Amp A-Series circuit breakers installed
- One double-pole 30 Amp AC main circuit breaker
- 0-150 Volt AC voltmeter

AC Features of 8184 **CE** Marked Panel only

- Three 8 Amp B-Series circuit breakers installed
- One double-pole 16 Amp AC main circuit breaker
- 0-250 Volt AC voltmeter

DC Features Common to 8084 and 8184 Panels

- Sixteen DC circuit breaker positions, ten 15A circuit breakers installed
- 8-16 Volt voltmeter with 3 position switch for multiple battery banks
- 0-50 Ampere DC ammeter with remote shunt
- All positive, ground and grounding buses installed, fully pre-wired

PN Description

8084	24 Position AC/DC Panel, A-Series Circuit Breakers
8184	24 Position AC/DC Panel, CE Marked, B-Series Circuit Breakers



8084 Panel

***CE** Marked version is 8184 Panel



Specifications

Voltage	8084 12 Volts DC / 120 Volts AC 8184 12 Volts DC / 230 Volts AC
Amperage	Panel Main Bus 100 AAC / 100 ADC
Weight	8.43 Lb / 3.73 Kg
Dimensions	10" / 254 mm high 14.75" / 374.65 mm wide



8085 Panel

***CE** Marked version is 8185 Panel



Specifications

Voltage	8085 12 Volts DC / 120 Volts AC 8185 12 Volts DC / 230 Volts AC
Amperage	Panel Main Bus 100 AAC / 100 ADC
Weight	8.43 Lb / 3.73 Kg
Dimensions	10.00" / 254.00 mm high 14.75" / 374.65 mm wide

AC/DC 16AC/8DC Position Circuit Breaker Panel

- Ready for installation of optional 8065 Label Backlight System (3 required)
- Includes set of 30 common AC and 30 common DC labels, backlightable (see page 29)
- All AC and DC buses installed, fully pre-wired

AC Features Common to 8085 and 8185 Panels

- Sixteen AC circuit breaker positions
- 0-50 Ampere AC ammeter with remote sensing coil
- Reverse Polarity Indicator

AC Features of 8085 Panel only

- Nine 15 Amp A-Series circuit breakers installed
- Two double-pole 30 Amp A-Series AC main circuit breakers with lockout slide
- 0-150 Volt AC voltmeter

AC Features of 8185 **CE** Marked Panel only

- Nine 8 Amp B-Series circuit breakers installed
- Two double-pole 16 Amp B-Series AC main circuit breakers with lockout slide
- 0-250 Volt AC voltmeter

DC Features Common to 8085 and 8185 Panels

- Eight DC circuit breaker positions, five 15A circuit breakers installed
- 8-16 Volt voltmeter with 3 position switch for multiple battery banks
- All positive, ground and grounding buses installed, fully pre-wired

PN Description

8085	24 Position AC/DC Panel, A-Series Circuit Breakers
8185	24 Position AC/DC Panel CE Marked, B-Series Circuit Breakers

AC 24 Position Circuit Breaker Panel

- Twenty-four total circuit breaker positions, 9 blank positions
- All hot, neutral and safety ground buses installed, fully pre-wired
- Includes set of 30 common AC labels, backlightable (see page 29)
- Ready for installation of optional 8065 Label Backlight Systems (3 required)

Features of 8265 Panel only

- Fifteen 15 Amp A-Series circuit breakers installed

Features of 8165 Panel only

- Fifteen 8 Amp B-Series circuit breakers installed

Specifications

Voltage	8265 120 Volts AC / 8165 230 Volts AC
Amperage	Panel Main Bus 100A
Weight	5.00 Lb / 2.72 Kg
Dimensions	7.50" / 190.50 mm high
	15.75" / 400.05 mm wide

PN	Description
----	-------------

8265	24 Position AC Panel, A-Series Circuit Breaker
8165	24 Position AC Panel, CE Marked, B-Series Circuit Breakers



8265 Panel

****CE** Marked version
is 8165 Panel*

AC Main + 11 Position Circuit Breaker Panel

- Thirteen total circuit breaker positions, 3 blank positions
- Red reverse polarity indicating LED
- 0-50 Ampere AC ammeter with remote sensing coil
- All hot, neutral and safety ground buses installed, fully pre-wired
- Includes set of 30 common AC labels, backlightable (see page 29)
- Ready for installation of optional 8065 Label Backlight System (2 required)

Features of 8076 Panel only

- Eight 15 Amp A-Series circuit breakers installed
- One double-pole 30 Amp A-Series AC main circuit breaker
- 0-150 Volt AC voltmeter

Features of 8176 **CE** Marked Panel only

- Eight 8 Amp B-Series circuit breakers installed
- One double-pole 16 Amp B-Series AC main circuit breaker
- 0-250 Volt AC voltmeter

Specifications

Voltage	8076 120 Volts AC / 8176 230 Volts AC
Amperage	Panel Main Bus 100A
Weight	4.06 Lb / 1.84 Kg
Dimensions	7.50" / 190.50 mm high
	10.50" / 266.80 mm wide

PN	Description
----	-------------

8076	13 Position AC Panel, A-Series Circuit Breakers
8176	13 Position AC Panel, CE Marked, B-Series Circuit Breakers



8076 Panel

****CE** Marked version
is 8176 Panel*

AC Main + 10 Position Circuit Breaker Panel

- Ten total circuit breaker positions, 3 blank positions
- Red reverse polarity indicating LED
- 0-50 Ampere ammeter with remote sensing coil
- All hot, neutral and safety ground buses installed, fully pre-wired
- Includes set of 30 common AC labels, backlightable (see page 29)
- Ready for Installation of optional 8069 Label Backlight System (1 required)

Features of 8074 Panel only

- Five 15 Amp A-Series circuit breakers installed
- One double-pole 30 Amp A-Series AC main circuit breaker installed
- 0-150 Volt AC voltmeter

Features of 8174 **CE** Marked Panel only

- Five 8 Amp B-Series circuit breaker installed
- One double-pole 16 Amp B-Series AC main circuit breaker installed
- 0-250 Volt AC voltmeter

Specifications

Voltage	8074 120 Volts AC / 8174 230 Volts AC
Amperage	Panel Main Bus 100A
Weight	4.06 Lb / 1.84 Kg
Dimensions	11.25" / 285.75 mm high
	5.25" / 133.40 mm wide

PN	Description
----	-------------

8074	10 Position AC Panel, A-Series Circuit Breakers
8174	10 Position AC Panel, CE Marked, B-Series Circuit Breakers



8074 Panel

****CE** Marked version is
8174 Panel*

See pages 35-39 for meter specifications.

See pages 29-32 for circuit breaker panel accessories.

AC 5 Position Circuit Breaker Panel

- Five total circuit breaker positions, five circuit breakers installed
- 0-50 Ampere AC ammeter with remote sensing coil
- All hot, neutral and safety ground buses installed, fully pre-wired
- Includes set of 30 common AC labels, backlightable (see page 29)
- Ready for installation of optional 8065 Label Backlight System (1 required)

Features of 8098 Panel only

- Five 15 Amp A-Series circuit breakers installed
- 0-150 Volt AC voltmeter

Features of 8198 € Marked Panel only

- Five 8 Amp B-Series circuit breakers installed
- 0-250 Volt AC voltmeter

Specifications

Voltage	8098 120 Volts AC / 8198 230 Volts AC
Amperage	Meter 50A DC / Panel Main Bus 100A
Weight	4.06 Lb / 1.84 Kg
Dimensions	7.50" / 190.50 mm high 5.25" / 133.40 mm wide

PN Description

8098	5 Position AC Panel with Meters, A-Series Circuit Breakers
8198	5 Position AC Panel with Meters, € Marked, B-Series Circuit Breakers



8098 Panel
*€ Marked version is
8198 Panel

See pages 35-39 for meter specifications.

AC Main + 3 Position Circuit Breaker Panel

- Five total circuit breaker positions
- Red reverse polarity indicating LED
- All hot, neutral and safety ground buses installed, fully pre-wired
- Includes set of 30 common AC labels, backlightable (see page 29)
- Ready for installation of optional 8065 Label Backlight System (1 required)

Features of 8043 Panel only

- Three 15 Amp A-Series branch circuit breakers installed
- One double-pole 30 Amp A-Series AC main circuit breaker
- 0-150 Volt AC voltmeter

Features of 8143 € Marked Panel only

- Three 8 Amp B-Series, branch circuit breakers Installed
- One double-pole 16 Amp B-Series AC main circuit breaker
- 0-250 Volt AC voltmeter

Specifications

Voltage	8043 120 Volts AC / 8143 230 Volts AC
Amperage	Panel Main Bus 100A
Weight	1.91 Lb / 0.87 Kg
Dimensions	7.50" / 190.50 mm high 5.25" / 133.40 mm wide

PN Description

8043	AC Main Panel with Meter, A-Series Circuit Breakers
8143	AC Main Panel with Meter, € Marked, B-Series Circuit Breakers



8099 Panel
*€ Marked version is 8199 Panel

See pages 29-32 for circuit breaker panel accessories.



8043 Panel
*€ Marked version is
8143 Panel

See pages 35-39 for meter specifications.

AC Main + Four Position Horizontal Circuit Breaker Panel

- Six total circuit breaker positions
- Red reverse polarity indicating LED
- All hot, neutral and safety ground buses installed, fully pre-wired
- Includes set of 30 common AC labels, backlightable (see page 29)
- Ready for installation of optional 8065 Label Backlight System (2 required)

Features of 8099 Panel only

- Four 15 Amp A-Series circuit breakers installed
- One double-pole 30 Amp A-Series AC main circuit breaker

Features of 8199 € Marked Panel only

- Four 8 Amp B-Series circuit breakers installed
- One double-pole 16 Amp B-Series AC main circuit breaker

Specifications

Voltage	8099 120 Volts AC / 8199 230 Volts AC
Amperage	Panel Main Bus 100 Amperes
Weight	2.22 Lb / 1.00 Kg
Dimensions	3.75" / 95.25 mm high 10.50" / 266.70 mm wide

PN Description

8099	6 Position AC Horizontal with AC Main, A-Series Circuit Breakers
8199	6 Position AC Horizontal with AC Main, € Marked, B-Series Circuit Breakers



8097 Panel
*CE Marked version is 8197 Panel

AC 6 Position Horizontal
Circuit Breaker Panel

- Six total circuit breaker positions
- All hot, neutral and safety ground buses installed, fully pre-wired
- Includes set of 30 common AC labels, backlightable (see page 29)
- Ready for installation of optional 8065 Label Backlight System (2 required)

Features of 8097 Panel only

- Six 15 Amp A-Series circuit breakers installed

Features of 8197 CE Marked Panel only

- Six 8 Amp B-Series circuit breakers installed

Specifications

Voltage	8097 120 Volts AC / 8197 230 Volts AC
Amperage	Panel Main Bus 100 Amperes
Weight	2.20 Lb / 1.00 Kg
Dimensions	3.75" / 95.25 mm high 10.50" / 266.70 mm wide

PN Description

8097	6 Position AC Horizontal, A-Series Circuit Breakers
8197	6 Position AC Horizontal, CE Marked, B-Series Circuit Breakers

AC 8 Position
Circuit Breaker Panel

- Eight total circuit breaker positions, 3 blank positions
- All hot, neutral and safety ground buses installed, fully pre-wired
- Includes set of 30 common AC labels, backlightable (see page 29)
- Ready for installation of optional 8065 Label Backlight System

Features of 8059 Panel only

- Five 15 Amp A-Series circuit breakers installed

Features of 8159 CE Marked Panel only

- Five 8 Amp B-Series circuit breakers installed

Specifications

Voltage	8059 120 Volts AC 8159 230 Volts AC
Amperage	Panel Main Bus 100A
Weight	1.85 Lb / 0.84 Kg
Dimensions	7.50" / 190.50 mm high 5.25" / 133.35 mm wide

PN Description

8059	8 Position AC Panel, A-Series Circuit Breakers
8159	8 Position AC Panel, CE Marked, B-Series Circuit Breakers



8059 Panel
*CE Marked version is
8159 Panel

AC 3 Position Circuit Breaker Panel

- Three total circuit breaker positions
- All hot, neutral and safety ground buses installed, fully pre-wired
- Includes set of 30 common AC labels, backlightable (see page 29)
- Ready for installation of optional 8065 Label Backlight System

Features of 8058 Panel only

- Three 15 Amp A-Series circuit breakers installed

Features of 8158 CE Marked Panel only

- Three 8 Amp B-Series circuit breakers installed

Specifications

Voltage	8058 120 Volts AC 8158 230 Volts AC
Amperage	Panel Main Bus 100A
Weight	1.14 Lb / 0.52 Kg
Dimensions	3.75" / 95.25 mm high 5.25" / 133.35 mm wide

PN Description

8058	3 Position AC Panel, A-Series Circuit Breakers
8158	3 Position AC Panel, CE Marked, B-Series Circuit Breakers



8058 Panel
*CE Marked version is
8158 Panel

AC Main + 6 Position Circuit Breaker

- Eight total circuit breaker positions, 3 blank positions
- Red reverse polarity indicating LED
- Includes set of 30 common AC labels, backlightable (see page 29)
- Ready for installation of optional 8065 Label Backlight System (1 required)

Features of 8027 Panel only

- Three 15 Amp A-Series circuit breakers installed
- One double-pole 30 Amp A-Series AC main circuit breaker

Features of 8127 € Marked Panel only

- Three 8 Amp B-Series circuit breakers installed
- One double-pole 16 Amp B-Series AC main circuit breaker

Specifications

Voltage	8027 120 Volts AC 8127 230 Volts AC
Amperage	Panel Main Bus 100A
Weight	1.87 Lb / 0.85 Kg
Dimensions	7.50" / 190.50 mm, high 5.25" / 133.35 mm wide

PN Description

8027	8 Position AC Panel, A-Series Circuit Breakers
8127	8 Position AC Panel, € Marked, B-Series Circuit Breakers



8027 Panel

*€ Marked version is 8127 Panel

AC Main + 1 Position Circuit Breaker Panel

- Three total circuit breaker positions, 1 blank position
- Red reverse polarity indicating LED
- All hot, neutral and safety ground buses installed, fully pre-wired
- Ready for installation of optional 8065 Label Backlight System (1 required)

Features of 8029 Panel only

- One 30 Amp double-pole A-Series circuit breaker installed

Features of 8129 € Marked Panel only

- One 16 Amp double-pole B-Series circuit breaker installed

Specifications

Voltage	8029 120 Volts AC 8129 230 Volts AC
Amperage	Panel Main Bus 30A
Weight	0.95 Lb / 0.43 Kg
Dimensions	3.75" / 95.25 mm high 5.25" / 133.35 mm wide

PN Description

8029	3 Position AC Main Panel 30 Amp AC, A-Series Circuit Breakers
8129	3 Position AC Main Panel 16 Amp AC, € Marked, B-Series Circuit Breakers



8029 Panel

*€ Marked version is 8129 Panel

AC Source Selector Panel

- Red reverse polarity indicating LED
- Two double-pole AC main circuit breakers with lockout slide
- All hot, neutral and safety ground buses installed, fully pre-wired
- Two green Power Available indicating LED's
- Allows connecting two different AC sources to a circuit
- Prevents connecting both AC sources simultaneously

Features of 8032 Panel only

- Two 30 Amp double-pole A-Series circuit breakers installed

Features of 8061 Panel only

- Two 50 Amp double-pole A-Series circuit breakers installed

Features of 8132 € Marked Panel only

- Two 16 Amp double-pole B-Series circuit breakers installed

Features of 8161 € Marked Panel only

- Two 32 Amp double-pole B-Series circuit breakers installed

Specifications

Voltage	8032 / 8061 120 Volts AC 8132 / 8161 230 Volts AC
Weight	1.84 Lb / 0.83 Kg
Dimensions	3.75" / 95.25 mm high 5.25" / 133.35 mm wide

PN Description

8032	AC Source Selector 30 Amp AC, A-Series Circuit Breakers
8132	AC Source Selector 16 Amp AC, € Marked, B-Series Circuit Breakers
8061	AC Source Selector 50 Amp AC, A-Series Circuit Breakers
8161	AC Source Selector 32 Amp AC, € Marked, B-Series Circuit Breakers



8032 Panel

*€ Marked version is 8132 Panel

8061 Panel

*€ Marked version is 8161 Panel

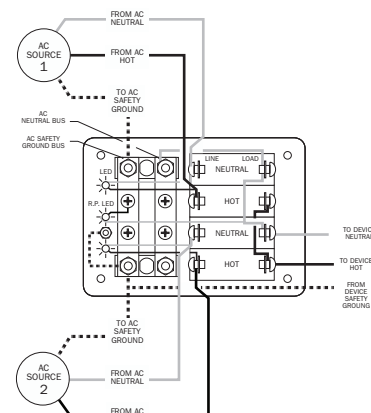

AC Panels

AC Main Circuit Breaker Panel

- Double-pole AC main circuit breaker
- Red reverse polarity indicating LED
- Safety ground screw on panel back

Features of 8077 Panel only

- One 30 Amp double-pole A-Series circuit breaker installed

Features of 8079 Panel only

- One 50 Amp double-pole A-Series circuit breaker installed

Features of 8177 C€ Marked Panel only

- One 16 Amp double-pole B-Series circuit breaker installed

Features of 8179 C€ Marked Panel only

- One 32 Amp double-pole B-Series circuit breaker installed

Specifications

Voltage	8077 / 8079 120 Volts AC 8177 / 8179 230 Volts AC
Weight	0.51 Lb / 0.23 Kg
Dimensions	3.75" / 95.25 mm high 2.625" / 66.675 mm wide

PN	Description
----	-------------

8077	AC Main Panel 30 AAC, A-Series Circuit Breakers
8177	AC Main Panel 16 AAC, C€ Marked, B-Series Circuit Breakers
8079	AC Main Panel 50 AAC, A-Series Circuit Breakers
8179	AC Main Panel 32 AAC, C€ Marked, B-Series Circuit Breakers



Cellular manufacturing at Blue Sea Systems gives each cell leader responsibility and authority for the complete product production process.



8077 Panel
*C€ Marked version is 8177 Panel
8079 Panel
*C€ Marked version is 8179 Panel

DC Panels

DC 24 Position Circuit Breaker Panel

- Twenty-four total circuit breaker positions, 9 blank positions
- All positive, negative and grounding buses installed, fully pre-wired
- Includes set of 30 common DC labels, backlightable (see page 29)
- Detailed installation instructions and cutout template
- Ready for installation of optional 8065 Label Backlight Systems (3 required)

Features of 8264 Panel only

- Fifteen 15 Amp A-Series circuit breakers installed

Features of 8164 Panel only

- Fifteen 15 Amp B-Series circuit breakers installed

Specifications

Voltage	8264 12 Volts DC
Amperage	Panel Main Bus 100A
Weight	5.00 Lb / 2.72 Kg
Dimensions	7.50" / 190.50 mm high 15.75" / 400.05 mm wide

PN	Description
----	-------------

8264	24 Position DC Panel, A-Series Circuit Breakers
8164	24 Position DC Panel, C€ Marked, B-Series Circuit Breakers



8264 Panel
*C€ Marked version is 8164 Panel



8068 Panel

**CE Marked version is 8168 Panel*

DC 13 Position Circuit Breaker Panel

- Thirteen total circuit breaker positions, 3 blank positions
- 8-16 Volt voltmeter with 3 position switch for multiple battery banks
- 0-50 Ampere ammeter with remote shunt
- All positive, negative and grounding buses installed, fully pre-wired
- Includes set of 30 common labels, backlightable (see page 29)
- Ready for installation of optional 8065 Label Backlight System (2 required)

Features of 8068 Panel only

- Ten 15 Amp A-Series circuit breakers installed

Features of 8168 CE Marked Panel only

- Ten 15 Amp B-Series circuit breakers installed

Specifications

Voltage	12 Volts DC
Amperage	Panel Main Bus 100A
Weight	4.06 Lb / 1.84 Kg
Dimensions	7.50" / 190.50 mm high 10.50" / 266.80 mm wide

PN Description

8068	13 Position DC Panel, A-Series Circuit Breakers
8168	13 Position DC Panel, CE Marked, B-Series Circuit Breakers

DC 6 Position Horizontal Circuit Breaker Panel

- Six total circuit breaker positions, six 15A circuit breakers installed
- All positive, negative and grounding buses installed, fully pre-wired
- Includes set of 30 common DC labels, backlightable (see page 29)
- Ready for installation of optional 8065 Label Backlight System (2 required)

Features of 8096 Panel only

- Six 15 Amp A-Series circuit breakers installed

Features of 8196 CE Marked Panel only

- Six 15 Amp B-Series circuit breakers installed

Specifications

Voltage	12 Volts DC
Amperage	Panel Main Bus 100 Amperes
Weight	2.20 Lb / 1.00 Kg
Dimensions	3.75" / 95.25 mm high 10.50" / 266.70 mm wide

PN Description

8096	6 Position DC Horizontal, A-Series Circuit Breakers
8196	6 Position DC Horizontal, CE Marked, B-Series Circuit Breakers



8096 Panel

**CE Marked version is 8196 Panel*

DC 5 Position Circuit Breaker Panel

- Five total circuit breaker positions, five 15A circuit breakers installed
- 8-16 Volt voltmeter with 3 position switch for multiple battery banks
- 0-50 ADC ammeter with remote shunt
- All positive, ground and grounding buses installed, fully pre-wired
- Includes set of 30 common DC labels, backlightable (see page 29)
- Ready for installation of optional 8065 Label Backlight system (1 required)

Features of 8081 Panel only

- Five 15 Amp A-Series circuit breakers installed

Features of 8181 CE Marked panel only

- Five 15 Amp B-Series circuit breakers installed

Specifications

Voltage	12 Volts DC
Amperage	Meter 50A DC / Panel Main Bus 100A
Weight	4.06 Lb / 1.84 Kg
Dimensions	7.50" / 190.5 mm high 5.25" / 133.35 mm wide

PN Description

8081	5 Position DC Panel with Meters, A-Series Circuit Breakers
8181	5 Position DC Panel with Meters, CE Marked, B-Series Circuit Breakers



8081 Panel

**CE Marked version is 8181 Panel*

See pages 35-39 for meter specifications.



8082 Panel
*CE Marked version is
8182 Panel

DC 10 Position Circuit Breaker Panel

- Ten total circuit breaker positions, 3 blank positions
- 8-16 Volt voltmeter with 3 position switch for multiple battery banks
- 0-50 Ampere ammeter with remote shunt
- All positive, negative and grounding buses installed, fully pre-wired
- Includes set of 30 common DC labels, backlightable (see page 29)
- Ready for installation of optional 8069 Label Backlight System (1 required)

Features of 8082 Panel only

- Seven 15 Amp A-Series circuit breakers installed

Features of 8182 CE Marked panel only

- Seven 15 Amp B-Series circuit breakers installed

Specifications

Voltage	12 Volts DC
Amperage	Panel Main Bus 100A
Weight	4.06 Lb / 1.84 Kg
Dimensions	11.25" / 285.75 mm high 5.25" / 133.35 mm wide

PN Description

8082	10 Position DC Panel, A-Series Circuit Breakers
8182	10 Position DC Panel, CE Marked, B-Series Circuit Breakers

DC 8 Position Circuit Breaker Panel

- Eight total circuit breaker positions, 3 blank positions
- All positive, negative and grounding buses installed, fully pre-wired
- Includes set of 30 common DC labels, backlightable (see page 29)
- Ready for installation of optional 8065 Label Backlight System (1 required)

Features of 8023 Panel only

- Five 15 Amp A-Series circuit breakers installed

Features of 8123 CE Marked panel only

- Five 15 Amp B-Series circuit breakers installed

Specifications

Voltage	12 Volts DC
Amperage	Panel Main Bus 100A
Weight	1.84 Lb / 0.83 Kg
Dimensions	7.50" / 190.50 mm high 5.25" / 133.35 mm wide

PN Description

8023	8 Position DC Panel, A-Series Circuit Breakers
8123	8 Position DC Panel, CE Marked, B-Series Circuit Breakers



8023 Panel
*CE Marked version is
8123 Panel

DC 3 Position Circuit Breaker Panel

- Three total circuit breaker positions
- All positive, negative and grounding buses installed, fully pre-wired
- Includes set of 30 common DC labels, backlightable (see page 29)
- Ready for installation of optional 8065 Label Backlight System (1 required)

Features of 8025 Panel only

- Three 15 Amp A-Series circuit breakers installed

Features of 8125 CE Marked panel only

- Three 15 Amp B-Series circuit breakers installed

Specifications

Voltage	12 Volts DC
Amperage	Panel Main Bus 100A
Weight	1.12 Lb / 0.61 Kg
Dimensions	3.75" / 95.25 mm high 5.25" / 133.35 mm wide

PN Description

8025	3 Position DC Panel, A-Series Circuit Breakers
8125	3 Position DC Panel, CE Marked, B-Series Circuit Breakers



8025 Panel
*CE Marked version is 8125 Panel

Vertical Series Waterproof Panels

- Designed for flybridge and open cockpit applications
- Rated IP66 - "Use on Shipdecks"
- Installed switch is ON-OFF

The features of a superior electrical panel:

- Waterproof panel mount fuse holders accept commonly available AGC (Fast Acting) and MDL (Slow Blow) 1-1/4" x 1/4"/32 mm x 6.5 mm glass fuses
- Countersunk mounting holes throughout
- Heavy 1/8" Aluminum Material
- Two-Part Polyurethane Slate Gray finish
- Waterproof Contura switches
- "ON" indicating LED's embedded in switch
- 450 labels available
- Industry standard height and width
- Waterproof mounting gasket
- Mil-Spec Chemical Treatment via immersion to protect every surface detail from corrosion
- All components waterproof from panel front
- Completely wired and ready to install
- Includes set of 30 common DC labels (see page 29)

NOTE: Waterproof Panel Labels are not back lightable

Specifications

Switch Rating	20 Amperes maximum
Switch LED Amperage	18 Milliampers each
Fuse Holder Rating	20 Amperes maximum
Panel Cumulative Rating	45 Amperes
Voltage	Panel front marked for 12 Volts

PN	Description	Switch Positions	Height in/mm	Width in/mm	Weight Lb/Kg
8053	Waterproof Electrical Panel	6	7.50/190.50	5.25/133.35	0.90/0.41
8054	Waterproof Electrical Panel	3	3.75/95.25	5.25/133.35	0.60/0.27



8053



8054



Panel Front withstands:

- Rain
- Sea Spray
- Hose Spray Washdown



8261

8262



Horizontal Series Waterproof Panels

- Specifications match the Vertical Series Waterproof Panels, but are designed for installations where height restrictions are present.
- New compact labels minimize panel space requirements
- Includes set of 60 common DC labels

PN	Description	Switch Positions	Height in/mm	Width in/mm	Weight Lb/Kg
8261	Waterproof Electrical Panel	8	3.75/95.25	9.37/238.00	1.34/0.61
8262	Waterproof Electrical Panel	4	3.75/95.25	5.25/133.35	0.77/0.35



8263



8055

Waterproof Bilge Pump Control Panels

- Specifications match the Vertical and Horizontal Series Waterproof Panels
- Installed switch is (ON)-OFF-AUTO

PN	Description	Height in/mm	Width in/mm	Weight Lb/Kg
8055	Bilge Pump Control Panel (ON)-OFF-AUTO Switch	1.875/47.62	5.25/133.35	0.23/0.10
8263	Bilge Pump Control Panel (ON)-OFF-AUTO Switch	3.75/95.25	2.25/57.15	0.43/0.20

Waterproof Panels Replacement Parts and Accessories



Waterproof Contura Switches

- Mounts in Blue Sea Systems' Waterproof Panels
- Blue Sea Systems' Contura Waterproof Switches are specially manufactured for mounting in Blue Sea Systems' waterproof panels. Use of standard Contura switches will not maintain the waterproof integrity of these panels.

Specifications

Rating	12 VDC	20 Amperes
Lighted		LED rated 100,000 hours 1/2 life
Seals		Internal & External Gasket Panel Seal
Temperature Rating		-40 C to 85 C
Mounting Hole		1.450" x 0.830" (36.83 mm x 21.08 mm)
LED Amperage		18 Milliampere

PN	Description	Poles/Throw	Action
8234	Rocker Switch Contura	SPDT	(ON)-OFF-(ON)
8233	Rocker Switch Contura	SPDT	(ON)-OFF - ON
8232	Rocker Switch Contura	SPDT	ON - OFF - ON
8231	Rocker Switch Contura	SPST	OFF - (ON)
8230	Rocker Switch Contura	SPST	OFF - ON

() = MOMENTARY POSITION

Label Set

- Tough, weatherproof Lexan® material

PN	Description
8214	Label Set (60 Labels) for Horizontal Waterproof Panels (8261, 8262, 8055)



See page 29 for Standard Label Sets for Vertical Series Waterproof Panels



Waterproof Fuse Holders

- Waterproof fuse holder will withstand water exposure normally encountered in above deck applications: salt spray, rain, hose washdown, or momentary immersion.

Specifications

Maximum Amperage	20 Amperes
Maximum Voltage	250 Volts AC/DC

PN	Description
5020	Fuseholder AGC Waterproof, Replacement

DC Basic Label Kit Part Number 8030

18	ACCESSORY
35	ANCHOR LIGHT
43	AUTOPILOT
61	BILGE PUMP
65	BLOWER
106	COMPASS LIGHT
131	DEPTH SOUNDER
148	ELECTRONICS
168	ENGINE INSTRUMENTS
179	FAN
197	FOREDECK LIGHT
217	FWD CABIN LIGHTS
232	GPS
270	HORN
288	KNOTMETER
292	LIGHTS
308	MACERATOR PUMP
312	MAIN CABIN LIGHTS
349	RADAR
356	REFRIGERATOR
362	RUNNING LIGHTS
364	SAILING INSTRUMENTS
389	SPARE
391	SPREADER LIGHTS
401	STEERING LIGHT
403	STEREO
408	STROBE LIGHT
421	TRICOLOR LIGHT
432	VHF
441	WATER PRESSURE

AC Basic Label Kit Part Number 8031

3	BLANK
18	ACCESSORY
22	AFT CABIN LIGHTS
23	AFT CABIN OUTLETS
26	AIR CONDITIONER
27	AIR CONDITIONER 2
39	APPLIANCES
50	BATTERY CHARGER
87	CABIN OUTLETS
107	COMPUTER
172	ENTERTAINMENT CENTER
217	FWD CABIN LIGHTS
218	FWD CABIN OUTLETS
219	GALLEY
224	GALLEY OUTLETS
257	HEATER
285	INVERTER
292	LIGHTS
308	MACERATOR PUMP
312	MAIN CABIN LIGHTS
313	MAIN CABIN OUTLETS
318	MICROWAVE
333	OUTLETS
356	REFRIGERATOR
389	SPARE
406	STOVE
425	TV/STEREO
431	VCR
436	WASHER DRYER
438	WATER HEATER

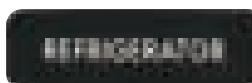

Panel Labels

- Tough, weatherproof Lexan® material
- Backlightable with Label Backlight System
- Over 450 circuit labels available

PN	Description	Weight
8063	Label Panel Single*	(specify #)
8031	Label Kit AC Panel Basic	(30 Labels)
8067	Label Kit AC Panel Extended	(120 Labels)
8030	Label Kit DC Panel Basic	(30 Labels)
8039	Label Kit DC Panel Extended	(120 Labels)

*See pages 52-53 for label listing and part numbers

Label Backlight System

- Easily installed in Blue Sea Systems' circuit breaker panels
- Connects to 12 Volt source via two 6" 18 AWG wire leads (available as 12/24 Volt DC beginning June 2001)

Specifications

Voltage	12 Volts DC
Amperage Draw	5 Milliampers per label

PN	Description	Weight Lb/Kg
8065	Backlight System 8/5/3 Positions	0.07/0.03
8069	Backlight System 10 Position	0.09/0.04

8065

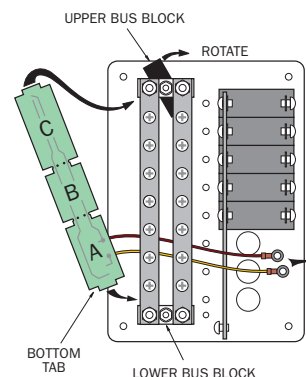
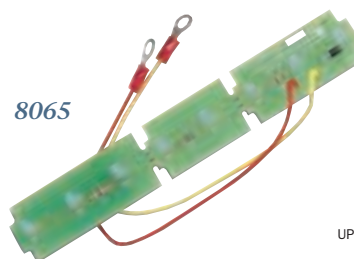

The backlight board is mounted between the 2 black bus support blocks on the back of the panel as shown.

The 8065 backlight board is easily shortened to fit all Blue Sea Systems' backlightable panels with 5 or 3 label positions. For panels with 8 label positions, no shortening of the boards is necessary. For panels with 5 label positions, snap off Section C furthest from the wire leads. For panels with 10 label positions, use the 8069 backlight board.

Loosen the single screw retaining the lower bus block exactly 1 turn. Then loosen the upper screw 2 turns.

With the green LED's facing the panel, insert the bottom tab nearest the wire leads into the slot and rotate the lower block back into position. Lightly tighten both bus screws.





LED Indicator Lights

- Easily installed in any Blue Sea Systems' circuit breaker panel
- Simple push-in installation mounts in any thickness material
- Useful as general indicator and alarm lights

Specifications

Amperage Draw 12 Volts DC	5 Milliamperes
Amperage Draw 24 Volts DC	5 Milliamperes
Amperage Draw 120 Volts AC	0.5 Milliamperes
Amperage Draw 230 Volts AC	0.25 Milliamperes
Mounting Hole Size	11/64" (4.36 mm)

PN	Description	Voltage	Weight Lb/Kg
8033	LED Amber	12/24 VDC	0.07/0.03
8034	LED Green	120 VAC	0.07/0.03
8066	LED Red	120 VAC	0.07/0.03
8134	LED Green	230 VAC	0.07/0.03
8166	LED Red	230 VAC	0.07/0.03

Panel Back Circuit Breaker Insulating Covers

- Provides electrical insulation for exposed panel backs
- Provides mechanical protection for panel backs protruding into lockers
- Lightweight material is easily drilled for wire entrance and exit

Specifications

Material	ABS
----------	-----

PN	Description	Weight Lb/Kg
4026	Cover for 5-1/4" x 3-3/4"	0.09/0.04
4027	Cover for 5-1/4" x 7-1/2"	0.14/0.06
4028	Cover for 10-1/2" x 7-1/2"	0.39/0.18



Mounting Panel for A-Series Magnetic Circuit Breakers

- Mount any A-or B-Series single-pole and double-pole breaker

Specifications

Panel Material	0.125" Aluminum 5052 Alloy
Dimensions	2.625" / 66.675mm x 3.75" / 95.25mm

PN	Description	Weight Lb/Kg
8072	Mounting Panel Single Pole	0.08/0.04
8173	Mounting Panel Double Pole	0.08/0.04

Propane Gas Control System

- The smallest LPG control panel available
- Amber "ON" Indicating LED
- UL Listed Solenoid
- Solenoid operates on either high or low pressure side of regulator

Specifications

Panel Material	0.125" Aluminum 5052 Alloy
Coating	Chemical Treatment—front and back Two-Part Polyurethane Slate Gray—front
Solenoid Amperage Draw	0.750 Amperes
LED Amperage Draw	5 Milliamperes
Voltage	12 Volts DC
Dimensions	2.625" / 66.675mm x 3.75" / 95.25mm

PN	Description	Weight Lb/Kg
8071	Panel LPG Control with Solenoid	1.06/0.48
8075	Solenoid Only 1/4" Inlet	0.67/0.30



8071



8075



4100 (2 shown)

Toggle Guard

- Protects circuit breakers from being accidentally switched ON or OFF
- Fits all single-pole A- and B-Series circuit breakers shown on page 14
- Can be used on any brand of circuit breaker panel using standard A- or B-Series circuit breakers
- Uses circuit breaker mounting screw hole
- Includes 2 mounting screws

Specifications

Material	Acetal
Mounting Hole Size	#6 Flat Head Screw

PN	Description	Weight Lb/Kg
4100	Toggle Guard for A- and B-Series circuit breakers	0.05/0.02

AC Lockout Slide

- Allows only 1 of a pair of double-pole AC circuit breakers to be activated at a time
- Guarantees that AC power from 2 sources (power company and genset or inverter) will not be mixed
- Fits all double-pole A- and B-Series circuit breakers shown on page 15
- Uses circuit breaker mounting screw holes. Requires no special panel modification
- Includes mounting screws

Specifications

Material	Acetal
Mounting Screw Size	#6 Flat Head Screw

PN	Description	Weight Lb/Kg
4125	AC 2 Positon Lockout Slide	0.06/0.03
4126	AC 3 Positon Lockout Slide	0.07/0.03



4125



8047

8048

8050

Colored Circuit Identifiers

- Fits all single- and double-pole A-Series circuit breakers shown on pages 14-15
- Sold in packages of 3
- Differentiates AC from DC circuit or identifies related circuits

PN	Description	Weight Lb/Kg
8047	Yellow Circuit Breaker Identifier	0.023/0.011
8048	White Circuit Breaker Identifier	0.023/0.011
8050	Red Circuit Breaker Identifier	0.023/0.011

Circuit Breaker Mounting Screws

- Fits all single- and double-pole A-, B- and C-Series circuit breakers
- Sold in packages of 6

PN	Description	Weight Lb/Kg
8035	Circuit Breaker Mounting Screws 6-32 x 1/4" Flat Head	0.027/0.012



Circuit Breaker Panel Accessories

Panel Switches

- For applications such as starters, bilge pumps, horns, wipers and engine controls where switching, in addition to circuit protection, is required
- All Panel Switches mount in Blue Sea Systems' A- or B-Series circuit breaker panels
- Supplied with Mounting Adapter for standard 5/8" circuit breaker mounting hole
- Nickel-plated brass and phenolic non-corrosive construction

Specifications	Toggle Switches	Push Button Switch
Rating 250 VAC	10 Amperes	3 Amperes
Rating 125 VAC	15 Amperes	6 Amperes
Rating 32 VDC	15 Amperes	6 Amperes
Terminal Size	0.25" (6.35 mm)	0.25" (6.35 mm)
Terminal Type	Quick Connect Tab	Quick Connect Tab
Actuator Color	White	White

PN	Type	Poles/Throw	Action	Weight Lb/Kg
8200	Push Button	SPST	OFF-(ON)	0.07/0.03
8204	Toggle	SPST	OFF-ON	0.08/0.04
8205	Toggle	SPST	OFF-(ON)	0.08/0.04
8206	Toggle	SPDT	ON-OFF-ON	0.08/0.04
8207	Toggle	SPDT	(ON)-OFF-ON	0.08/0.04
8208	Toggle	SPDT	(ON)-OFF-(ON)	0.08/0.04
8209	Toggle	SP*	OFF-ON-(ON)	0.08/0.04
8210	Toggle	DPST	OFF-ON	0.08/0.04
8211	Toggle	DPDT	ON-OFF-ON	0.08/0.04
8212	Toggle	DPDT	(ON)-OFF-ON	0.08/0.04
SP* Progressive Two Circuit () = momentary				



8200



8204-8212

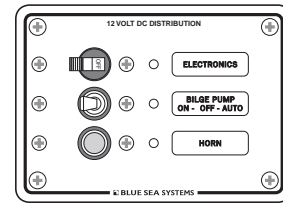
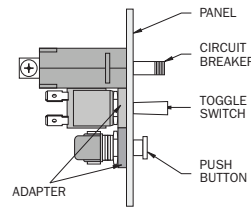

Panel Mounting Example

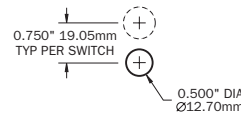

Panel Cutout Without Adapter

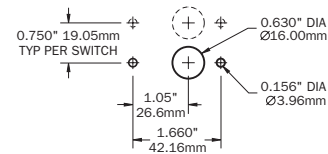

Panel Cutout With Adapter



8213

C-Series to A-Series Adaptor

- Allows an A-Series Circuit Breaker to be used in C-Series Panel (shown below)

PN	Description	Weight Lb/Kg
8213	C-Series to A-Series Adaptor	0.035/0.016

C-Series Circuit Breaker Mounting Panels

- Designed for C-Series circuit breakers available in sizes 50A to 300A
- Position plugs can be added or removed individually to fill blank positions or add new circuit breakers
- Heavy 1/8" aluminum 5052 Alloy
- Two-Part Polyurethane Textured Slate finish
- Accepts standard Blue Sea Systems' backlightable labels
- Ready for installation of optional 8065 Label Backlight System
- Accepts standard Blue Sea Systems' "ON" indicating LED's
- Industry standard height and width
- Optional Plug Kit PN 8089 includes circuit breaker mounting screws, C-Series panel plug, LED plug and blank label

Specifications		
Dimensions	8087	7.50"/190.50 mm high 5.25"/133.35 mm wide
Dimensions	8088	3.75"/95.25 mm high 5.25"/133.35 mm wide

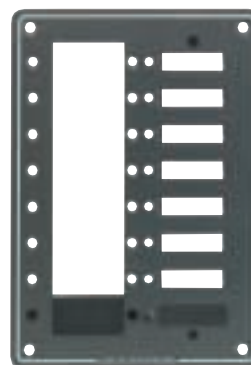

8087

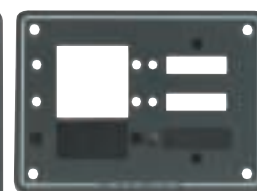

8088

PN	Description	Weight Lb/Kg
8087	8 Position C-Series Mounting Panel	0.40/0.18
8088	3 Position C-Series Mounting Panel	0.28/0.13
8089	C-Series Panel Plug Kit	0.10/0.04

See page 12 & 13 for High-Load™ C-Series circuit breakers.